

配 置 図

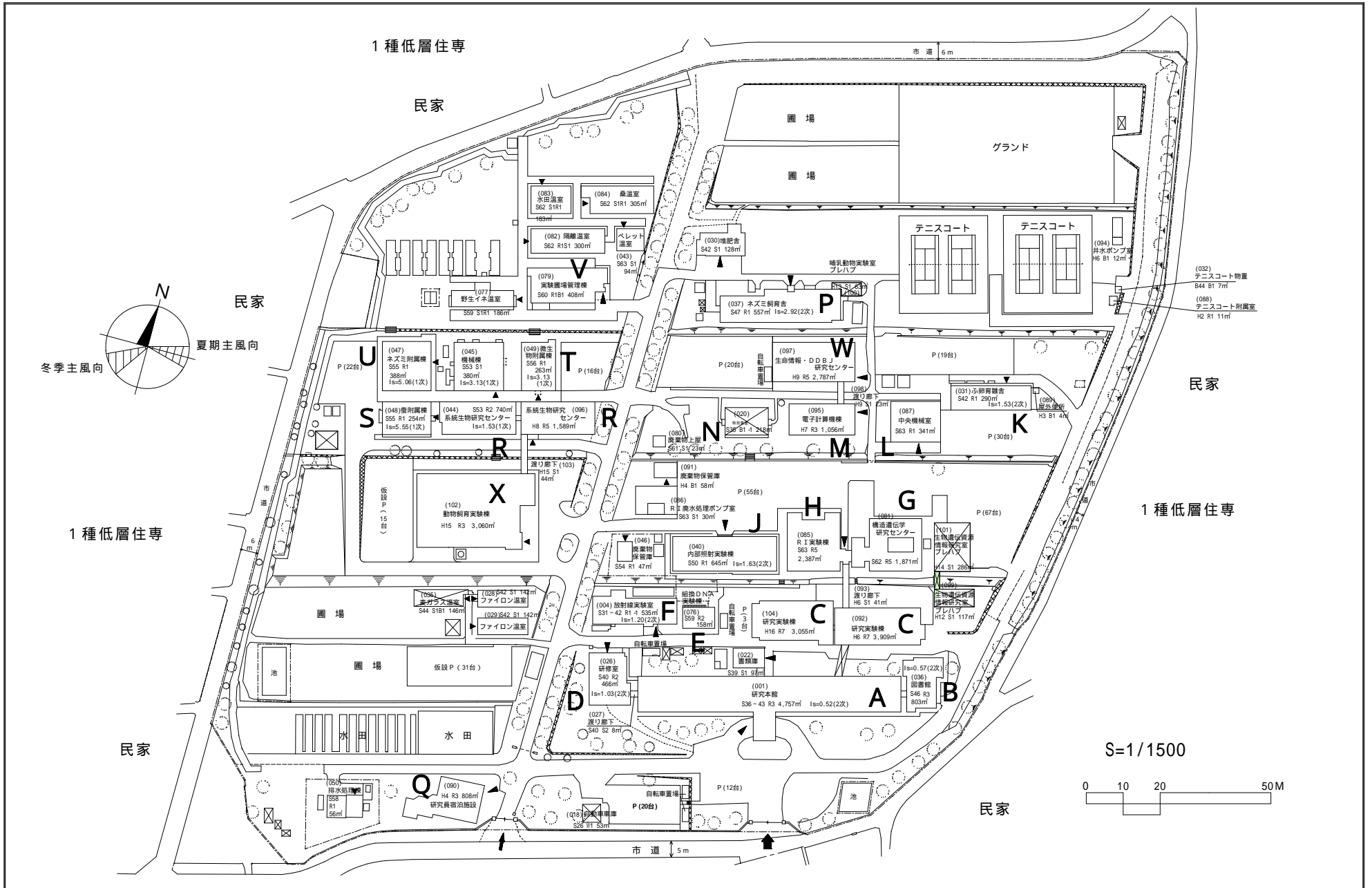

敷地面積	建築面積	建物延面積	建ぺい率	容積率	全学生数	学部等名	団地番号	団地名	所在地	学校番号	学校名	作成年度
96,069㎡	14,672㎡	34,333㎡	15%	36%	—	共同利用機関管理部 共同利用機関研究実験部	009	谷田1団地	静岡県三島市谷田1111	0894	情報・システム研究機構	H18年度

A 研究本館

2006.5.8

部屋番号整理

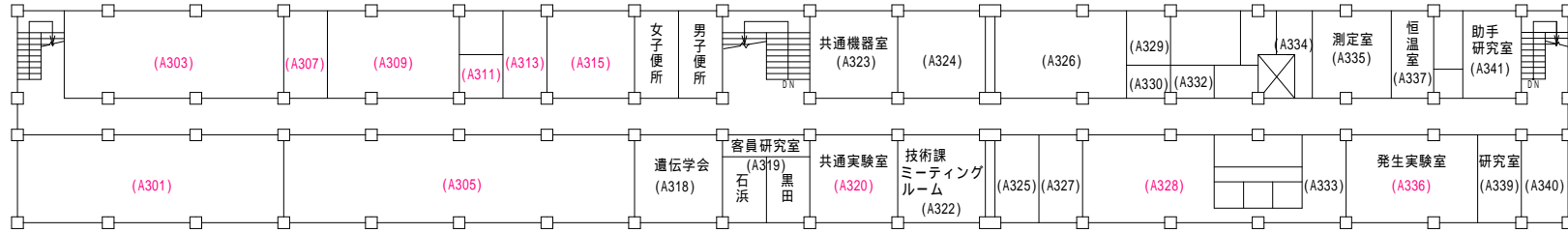
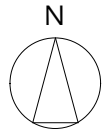
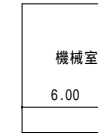
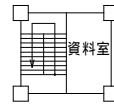

本館 3階 1,536m²

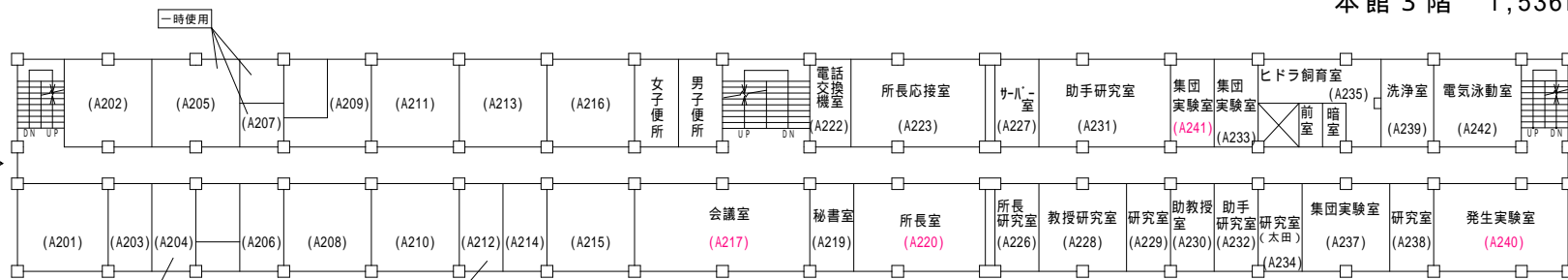

本館 2階 1,536m²

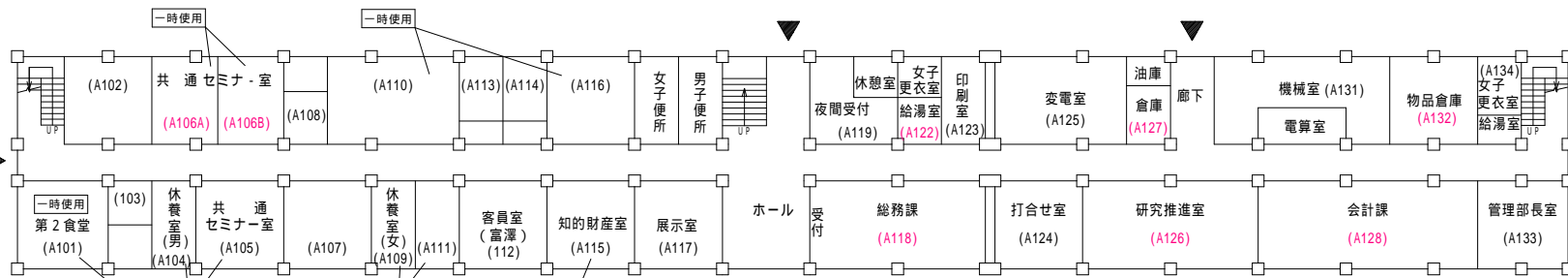

本館 1階 1,598m²

S = 1 / 5 0 0

B 図書館 2006.5.1

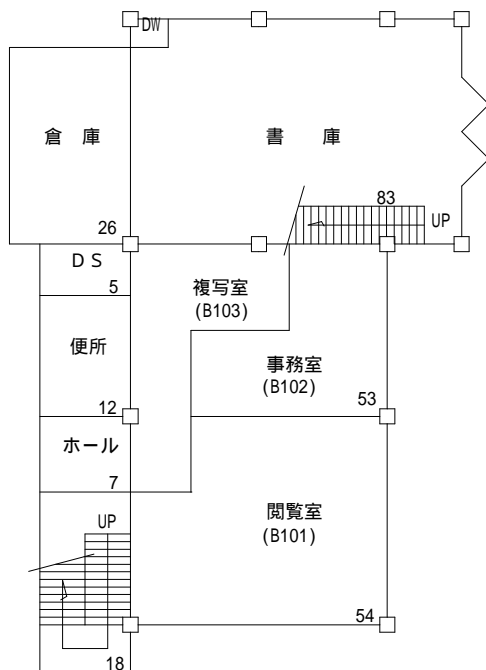

1階平面図 S.46 S=1/200 258m²

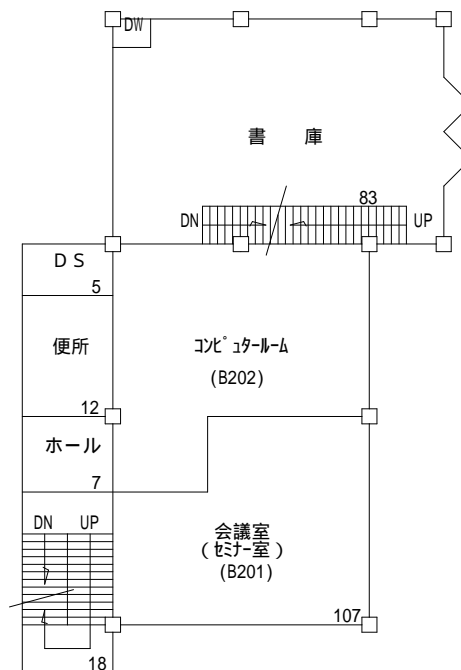

2階平面図 S.46 S=1/200 232m²

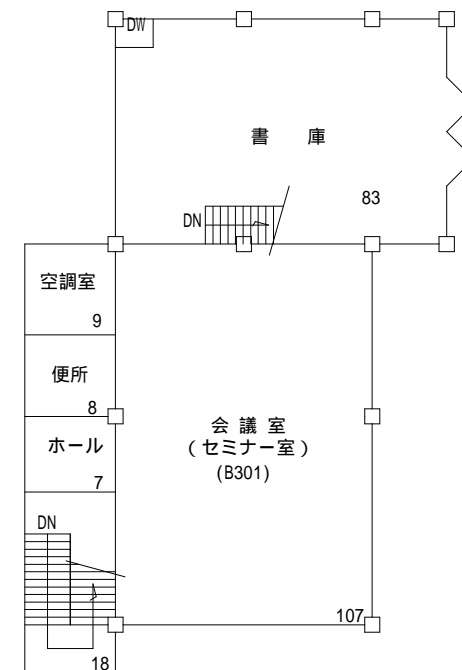

3階平面図 S.46 S=1/200 232m²

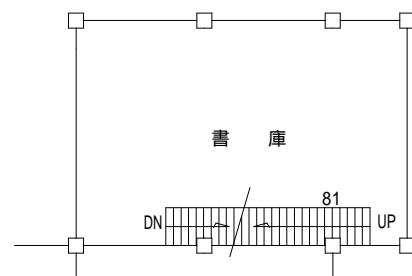

中2階平面図 S.46 S=1/200 81m²

S = 1 / 250

C 研究実験棟 (東棟)

2006.5.1

部屋番号整理

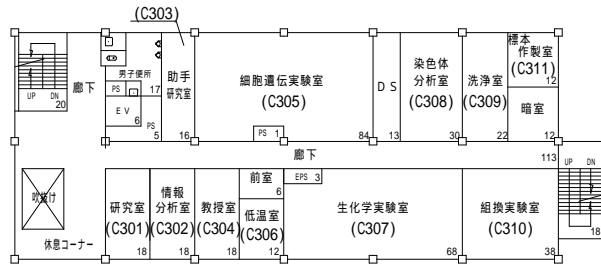

3階 550m²

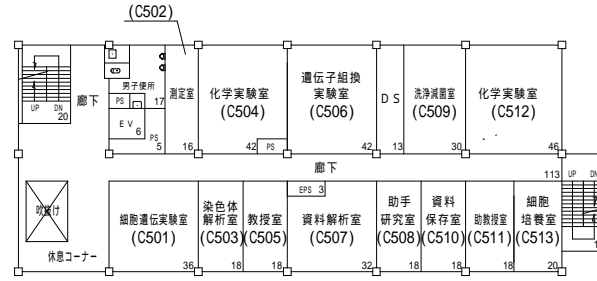

5階 550m²

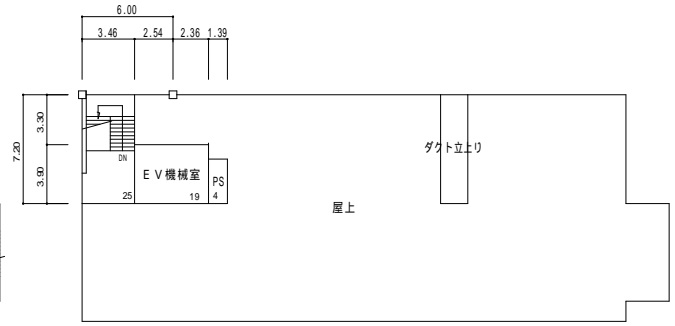

屋上階 48m²

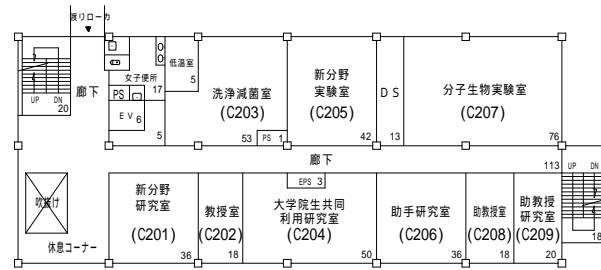

2階 550m²

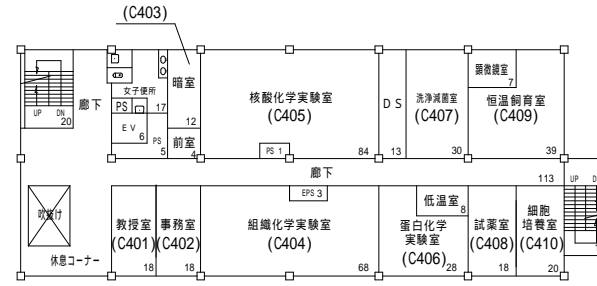

4階 550m²

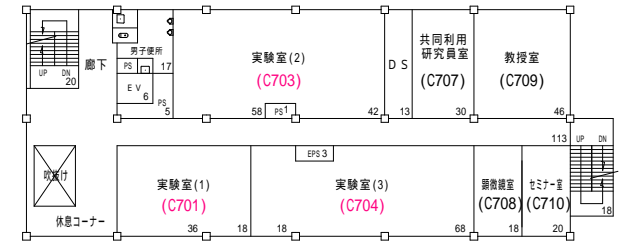

7階 550m²

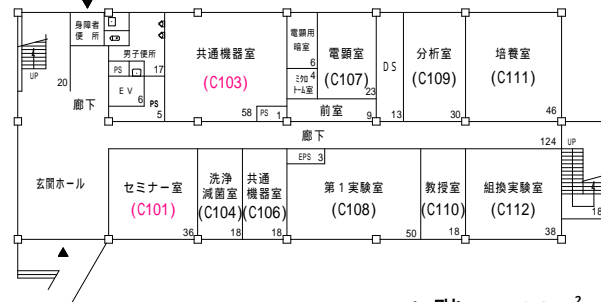

1階 561m²

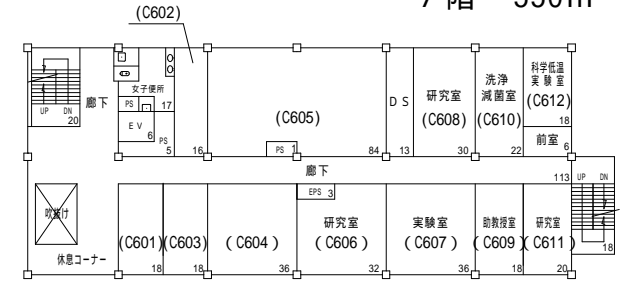

6階 550m²

C 研究実験棟 (西棟) 2006.5.8

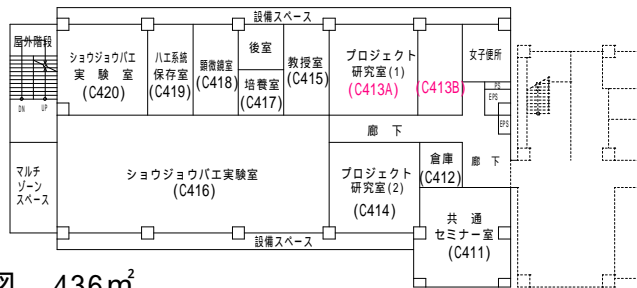

4階平面図 436m²

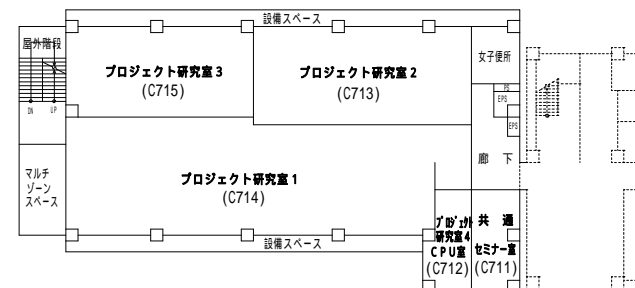

7階平面図 436m²

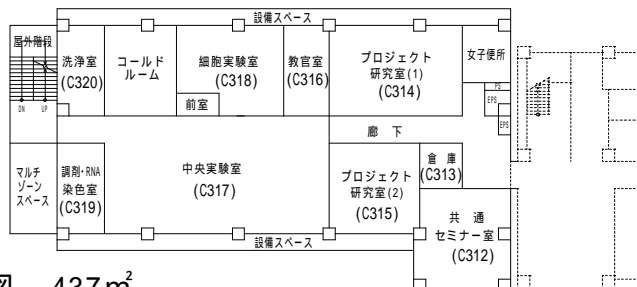

3階平面図 437m²

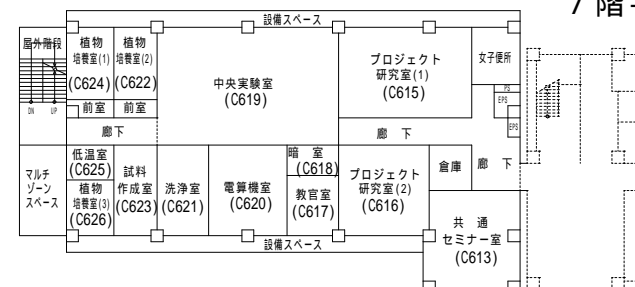

6階平面図 436m²

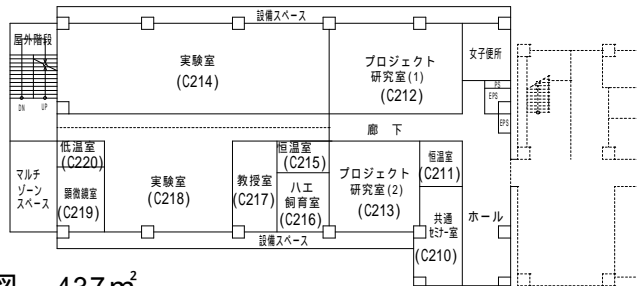

2階平面図 437m²

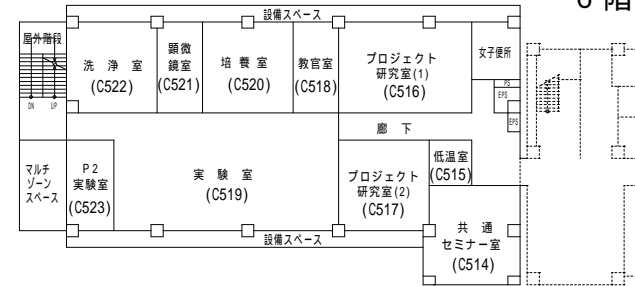

5階平面図 436m²

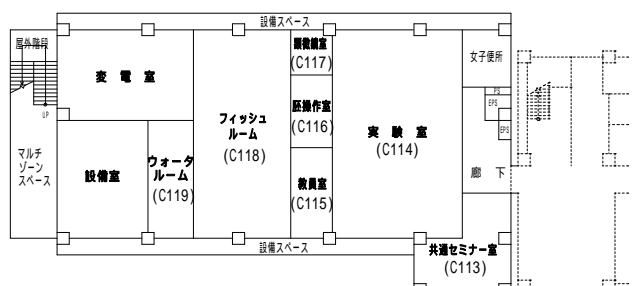

1階平面図 437m²

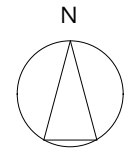

D 講堂・研修室 2006.5.1

部屋番号新設

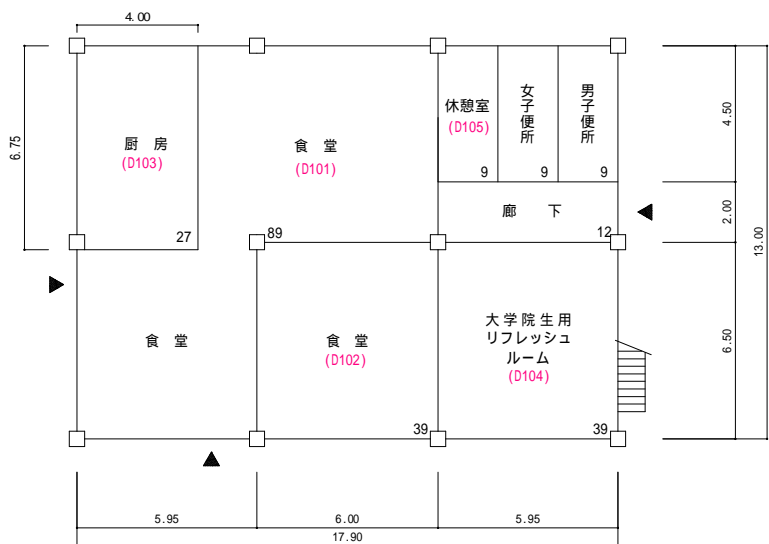
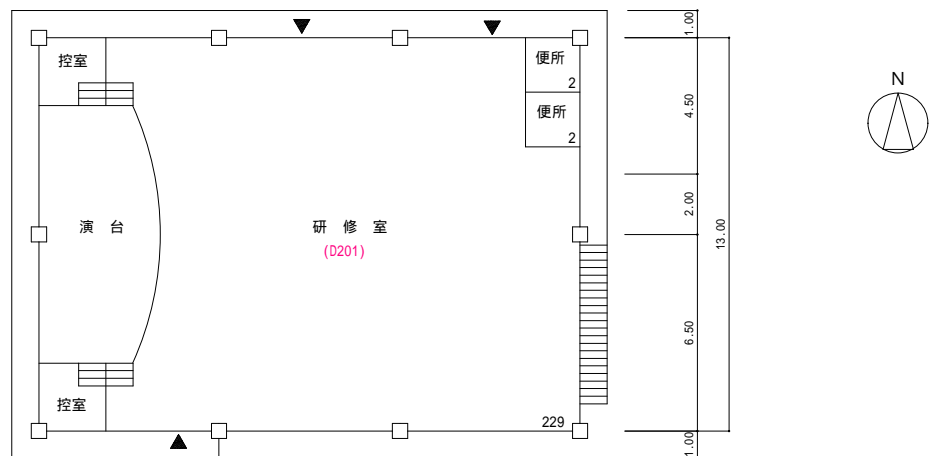

E 組換DNA実験棟

2006.5.1

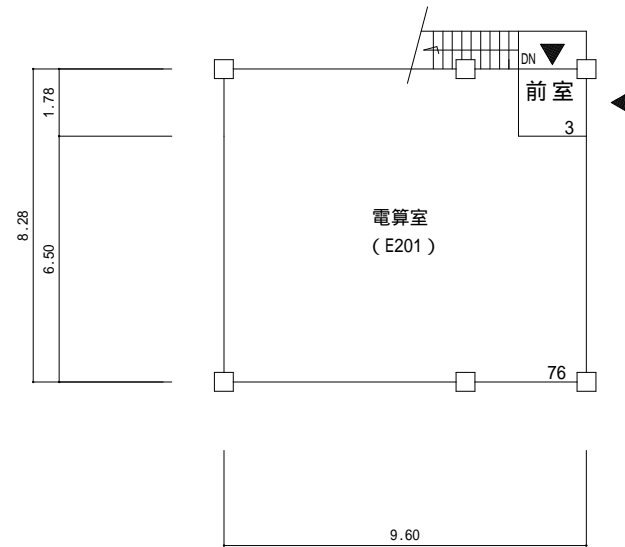

2階平面図 S.59 S=1/200 79m²

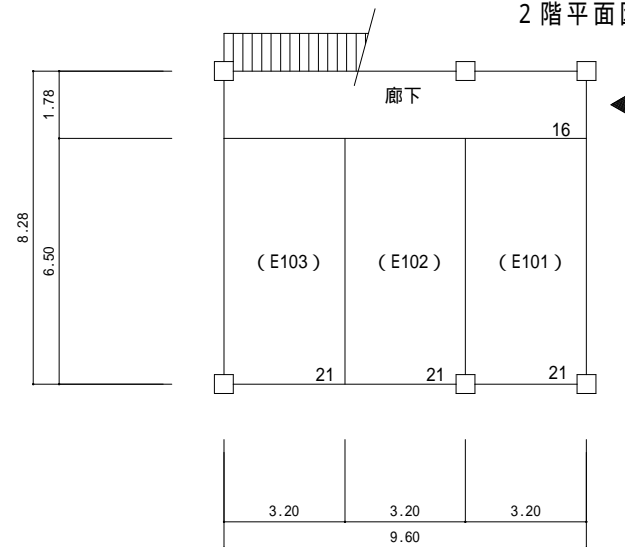

1階平面図 S.59 S=1/200 79m²

F 放射線実験室 2006.5.1

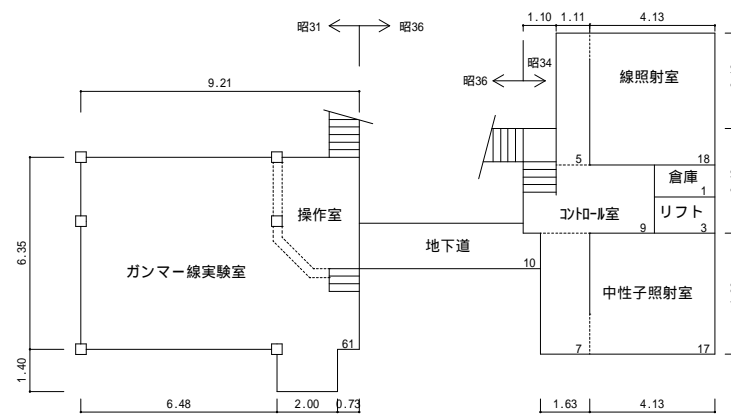
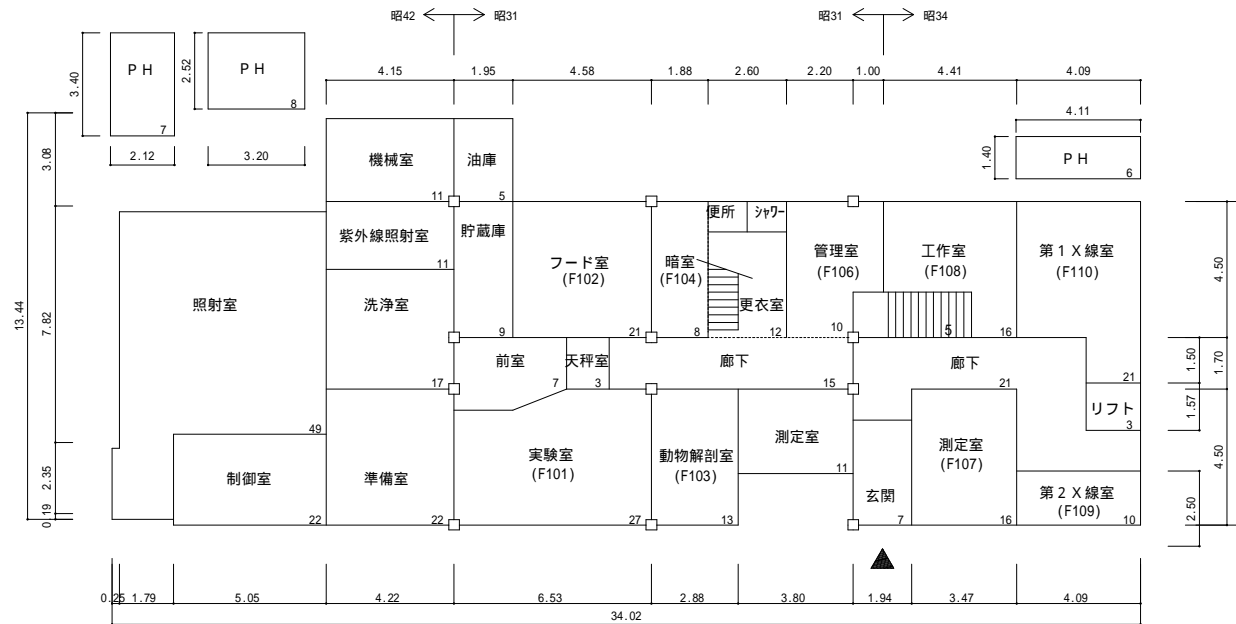

地下階平面図 S.31 S=1/200 131m²

G 構造遺伝学研究センター

2006.5.1

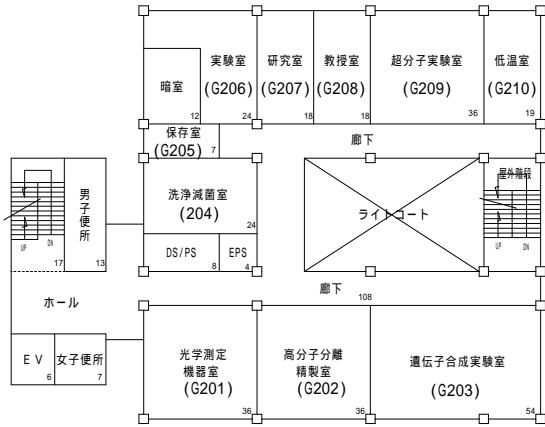

2階 447m²

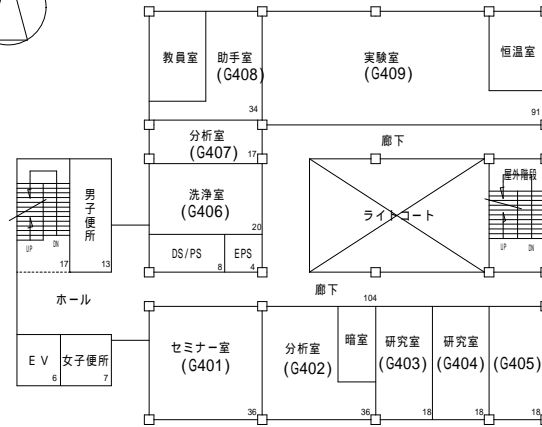

4階 447m²

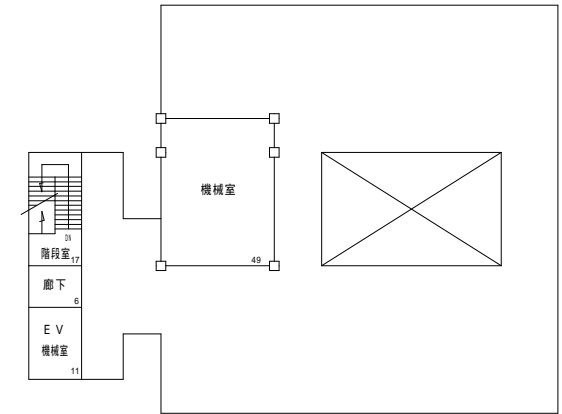

R階 83m²

S = 1 / 4 0 0

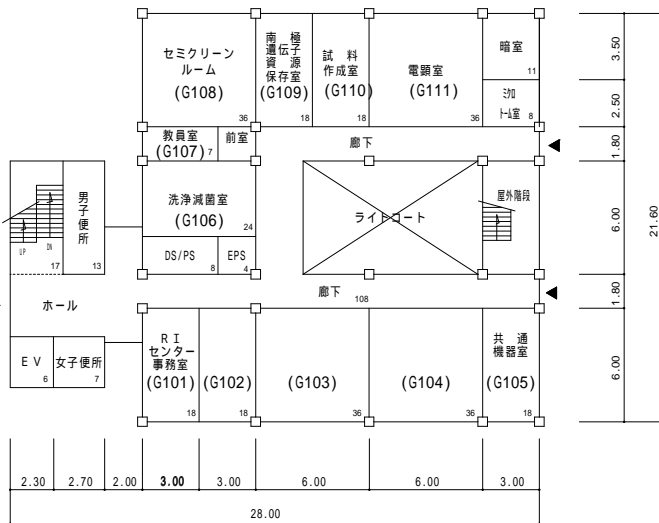

1階 447m²

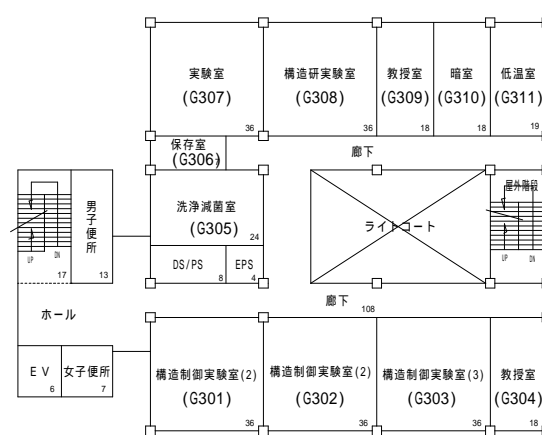

3階 447m²

H R I 実験棟

2006.5.1

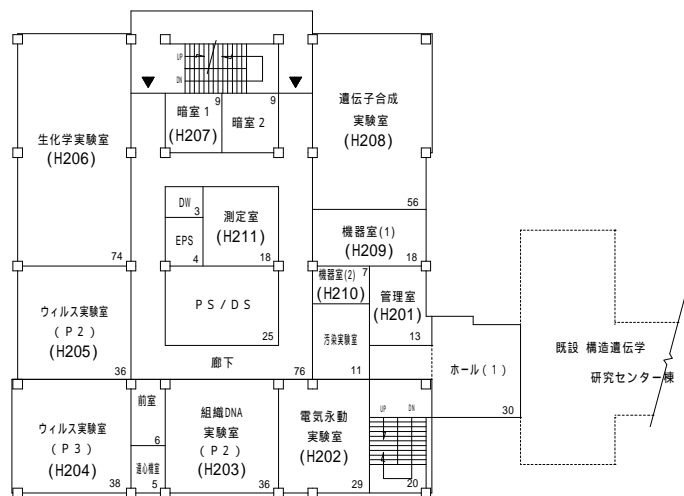

2階 523m²

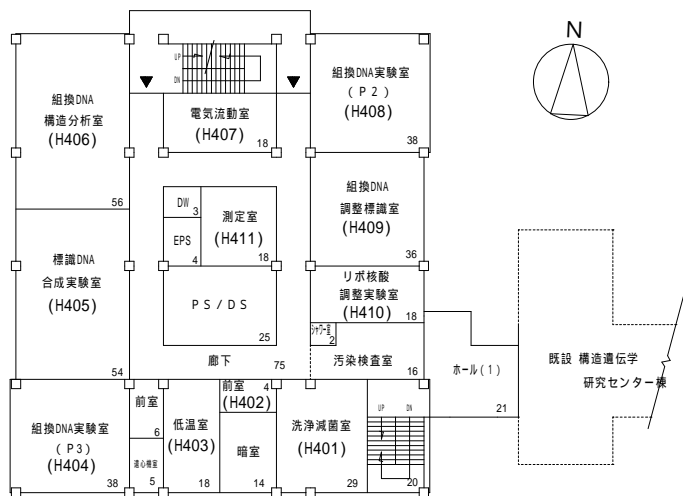

4階 518m²

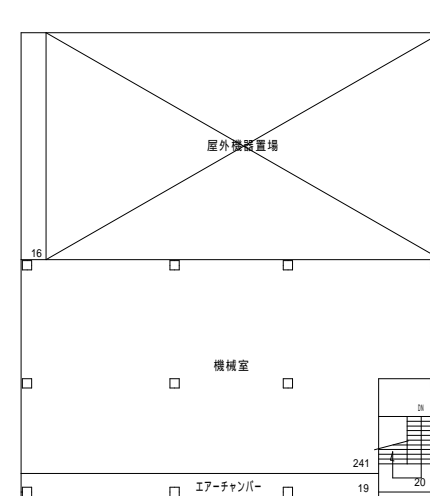

5階 296m²

S = 1 / 5 0 0

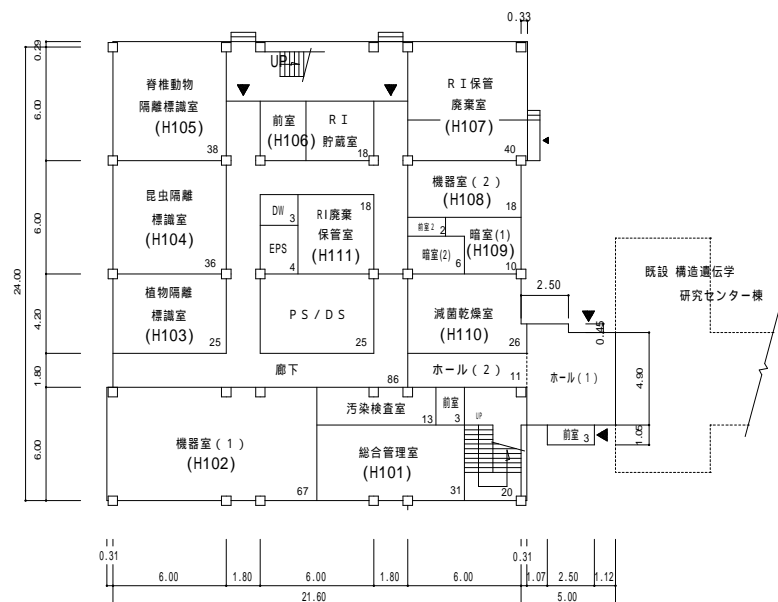

1階 527m²

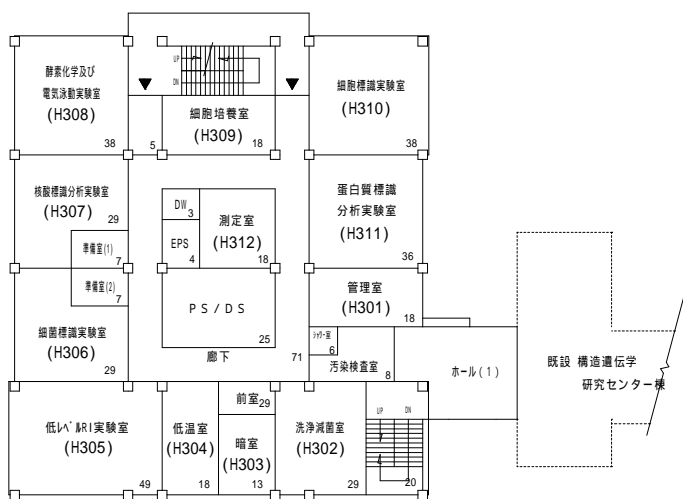

3階 523m²

J 内部照射実験棟

2006.5.1

R 階平面図 S.50 S=1/200 54m²

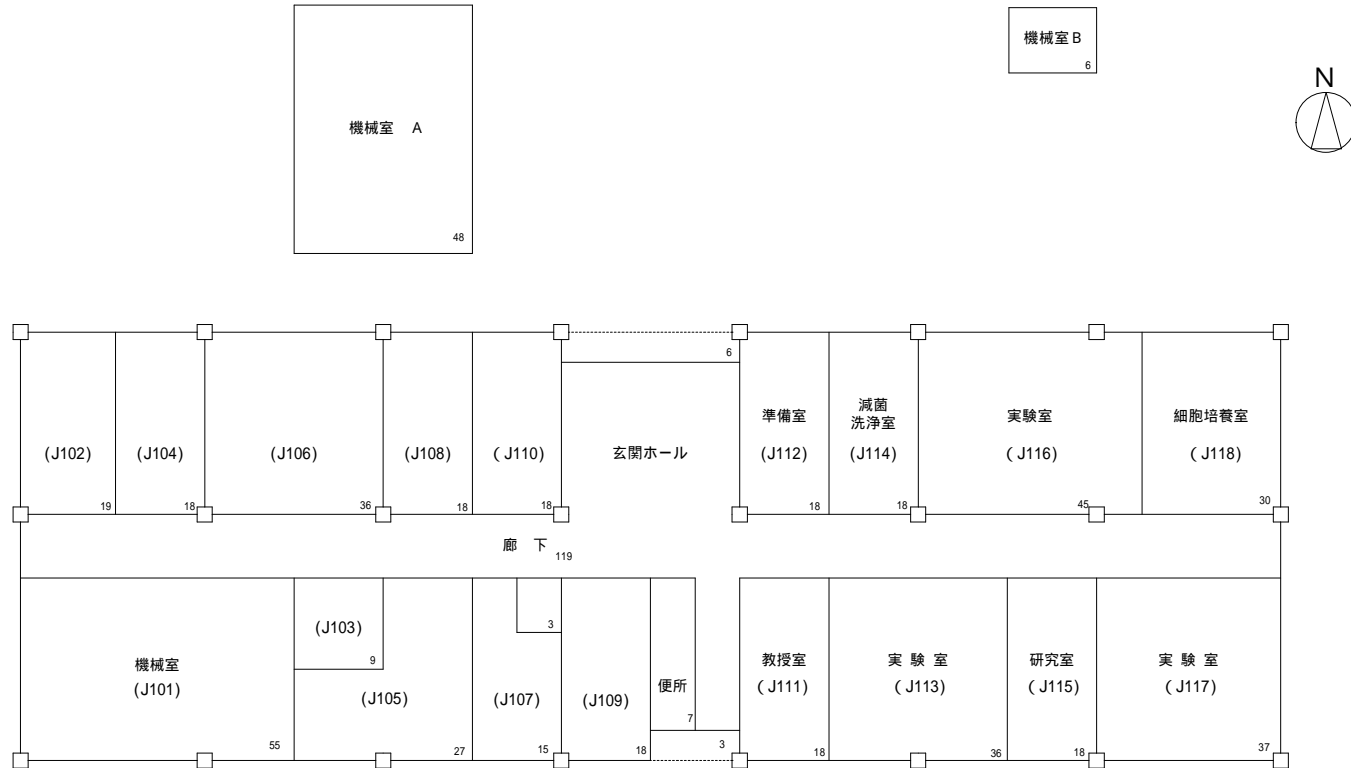

1 階平面図 S.50 S=1/250 591m²

K 心卵育雑舎

2006.5.1

部屋番号新設

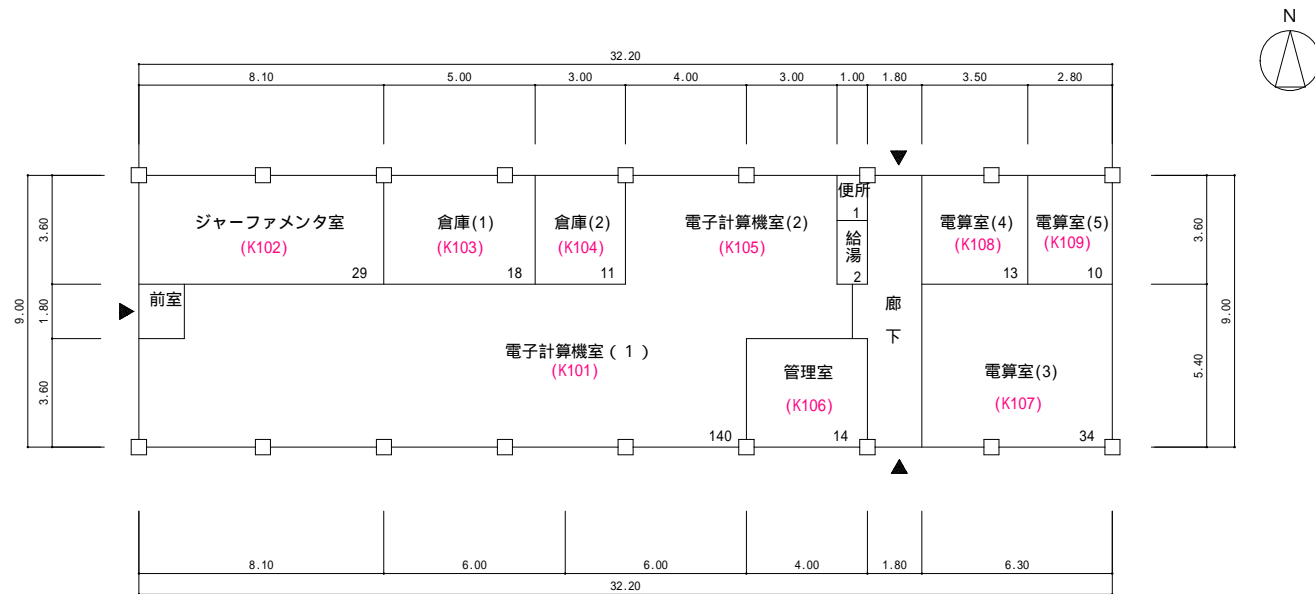

1階平面図 S.42 S=1/250 290m²

M 電子計算機棟

2006.5.1

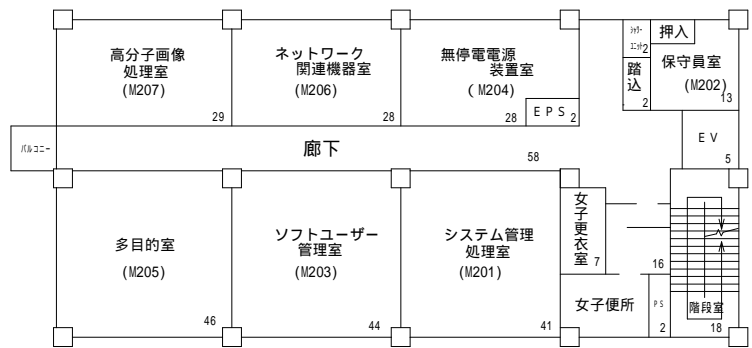
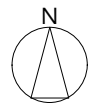

2階 341m²

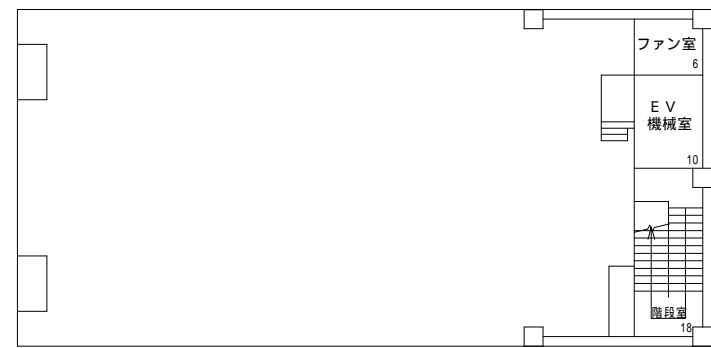

屋上階 34m²

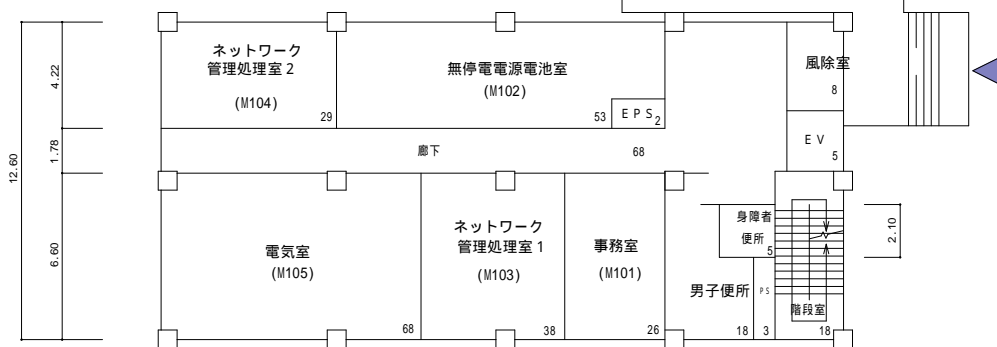

1階 341m²

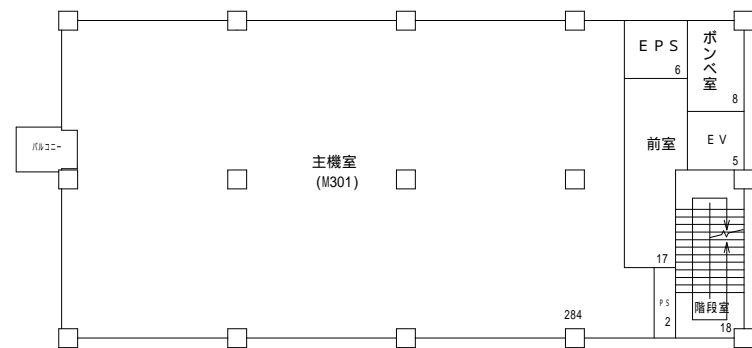

S = 1 / 3 0 0

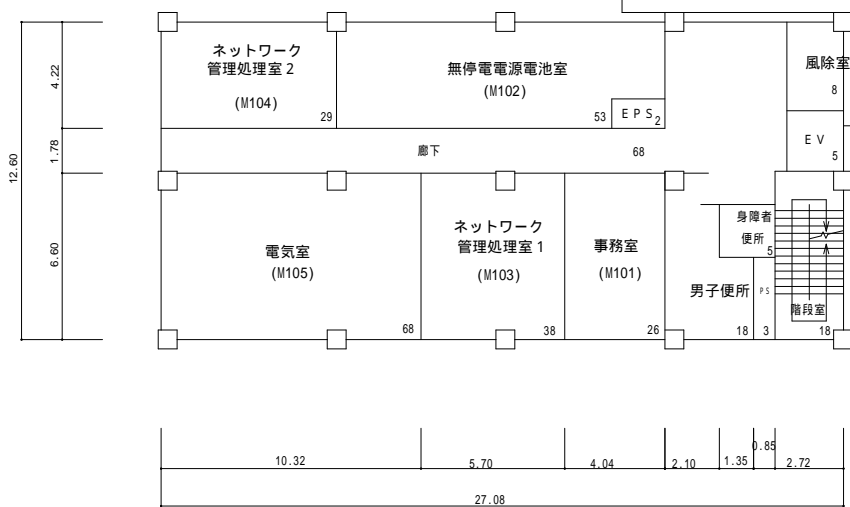

P ネズミ飼育舎 2006.5.1

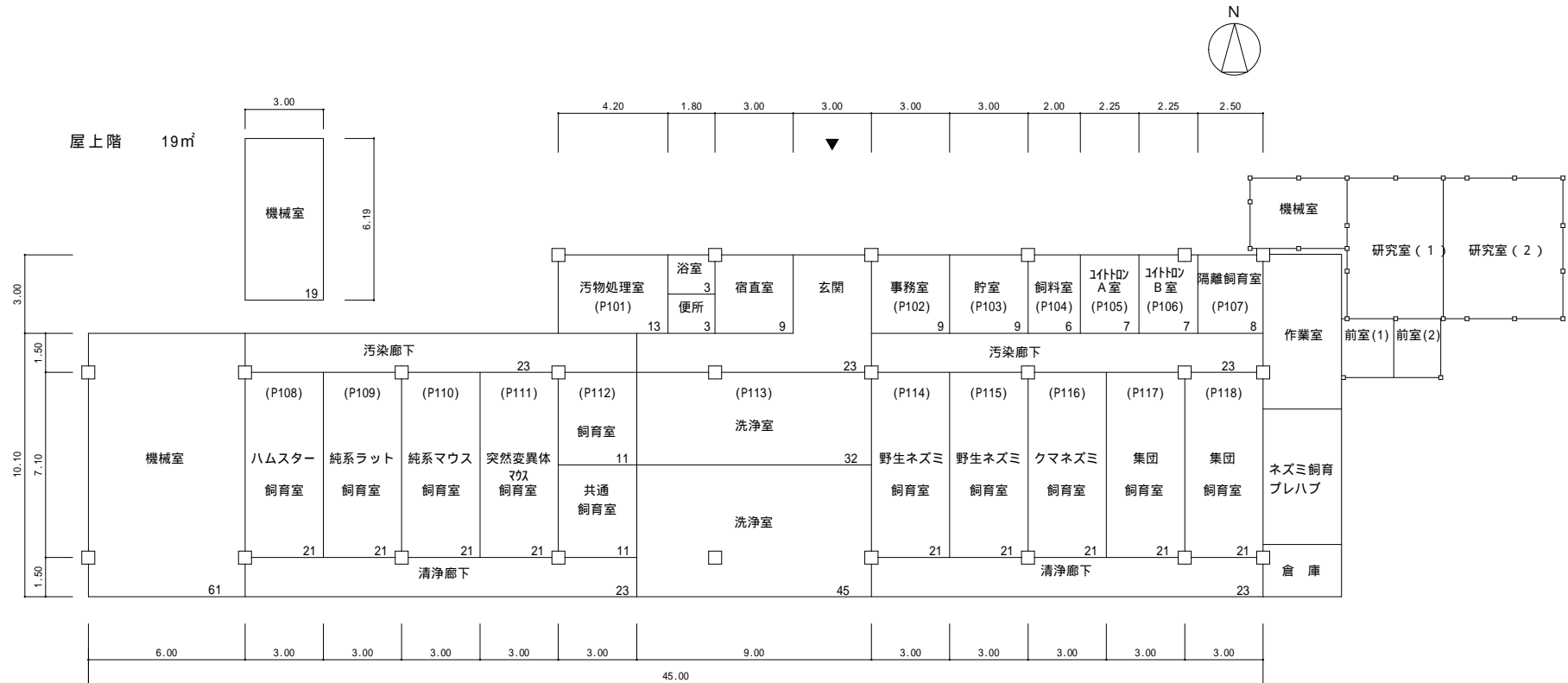

1階 538m²

Q 研究員宿泊施設

2006.5.8

部屋番号新設

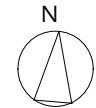
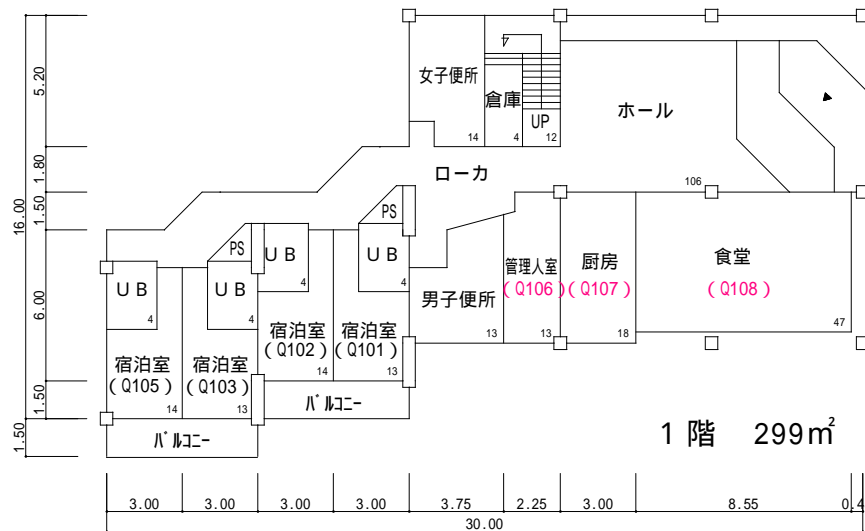
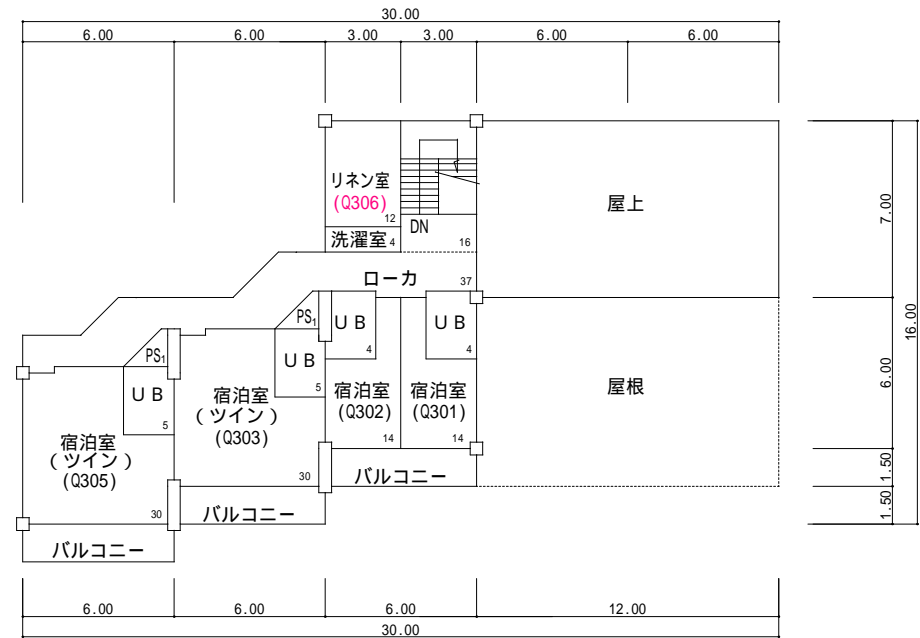
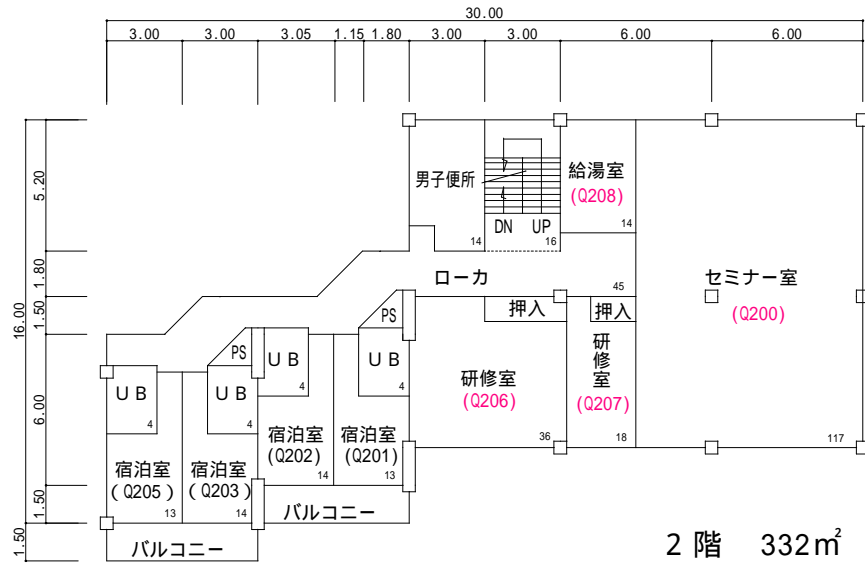

S = 1 / 3 0 0

R 系統生物研究センター (西棟) 2006.5.8

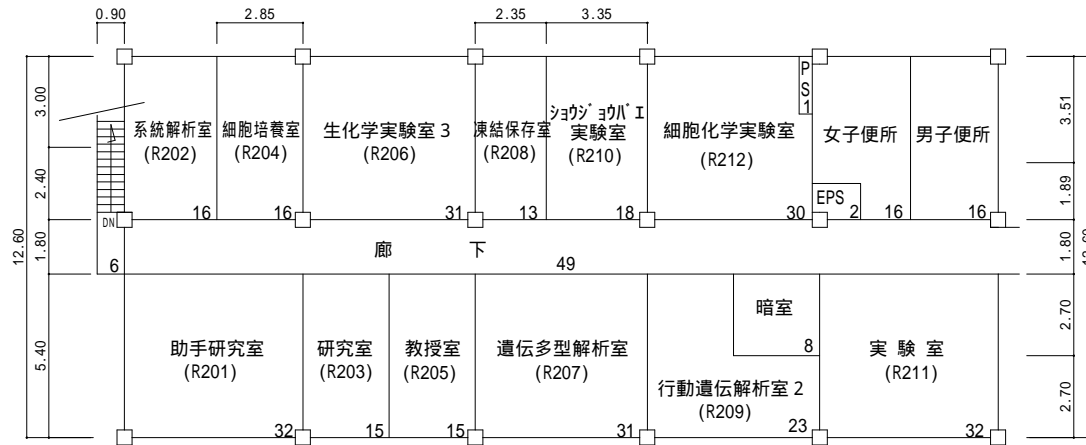
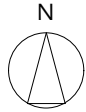

2階 370m²

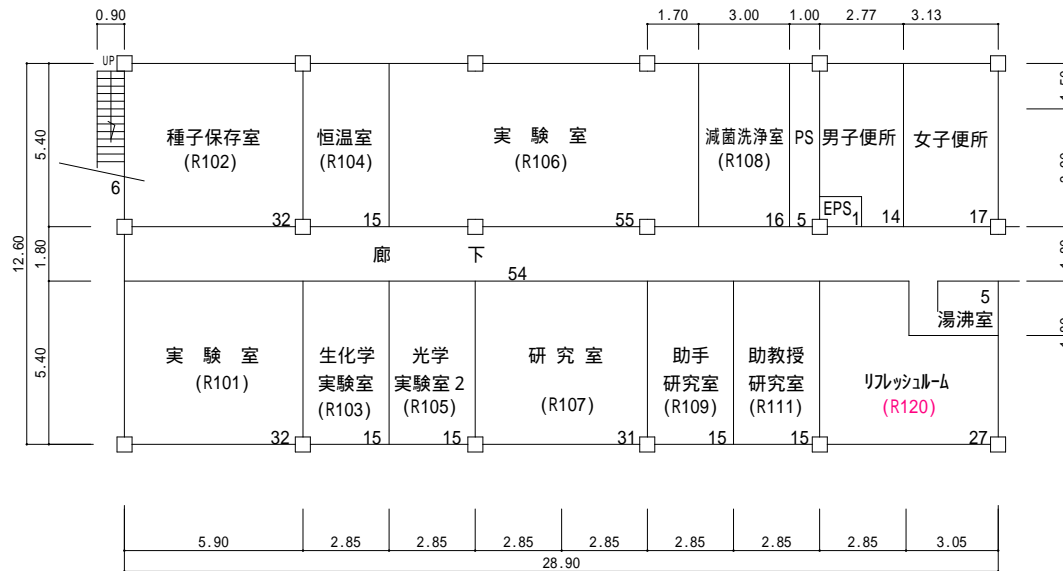

1階 370m²

$$S = 1 / 250$$

R 系統生物研究センター (東棟) 2006.5.8

部屋番号新設

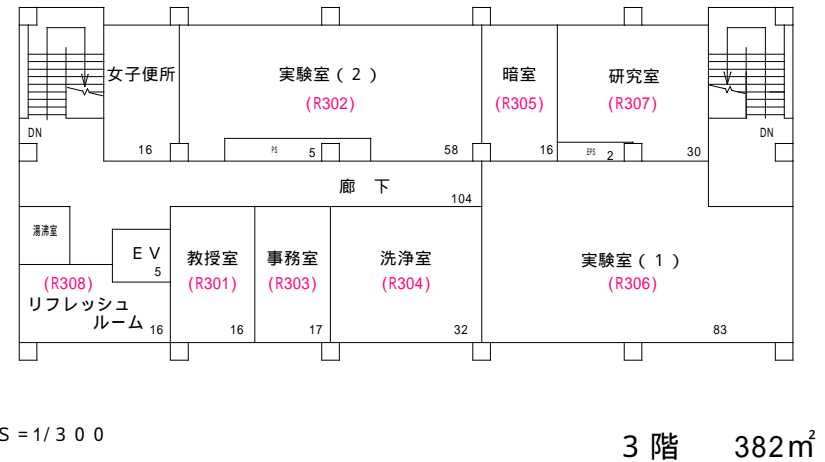
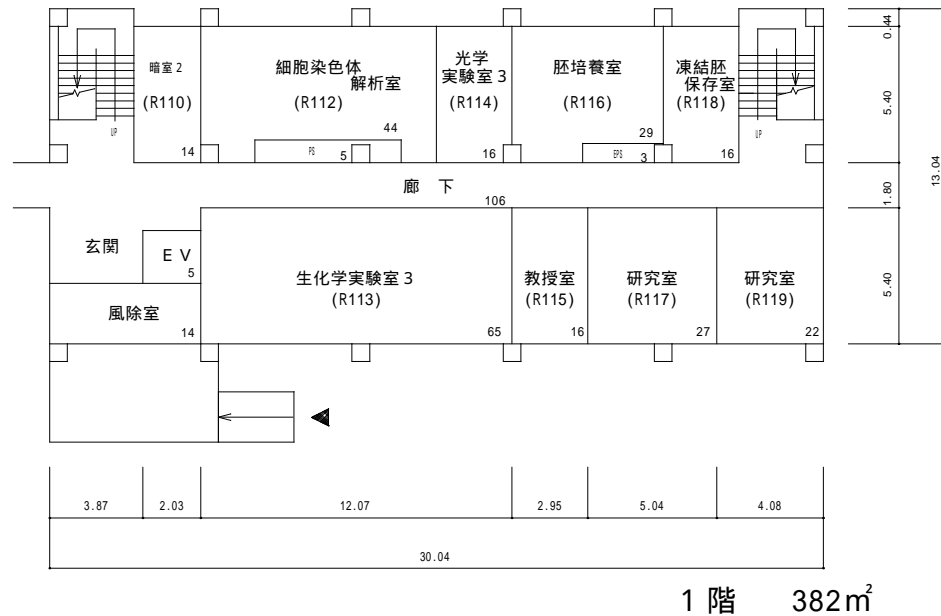
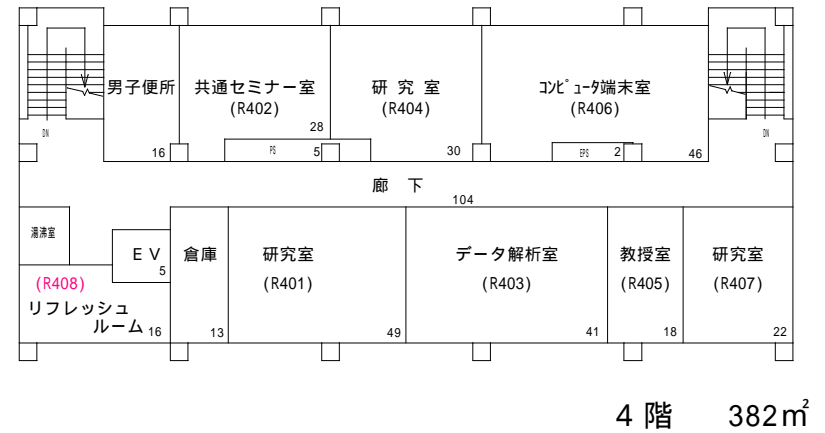
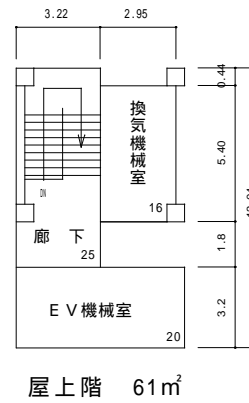
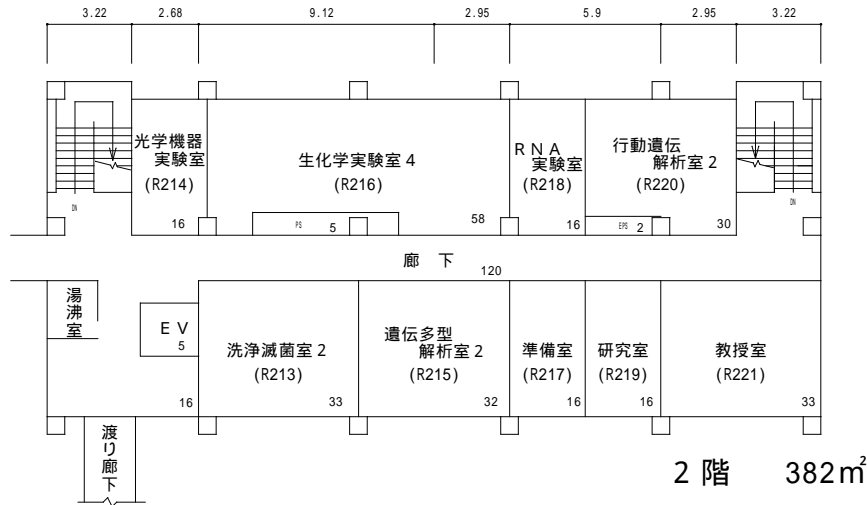

S = 1/300

S 蚕附属棟 2006.5.1

部屋番号整理

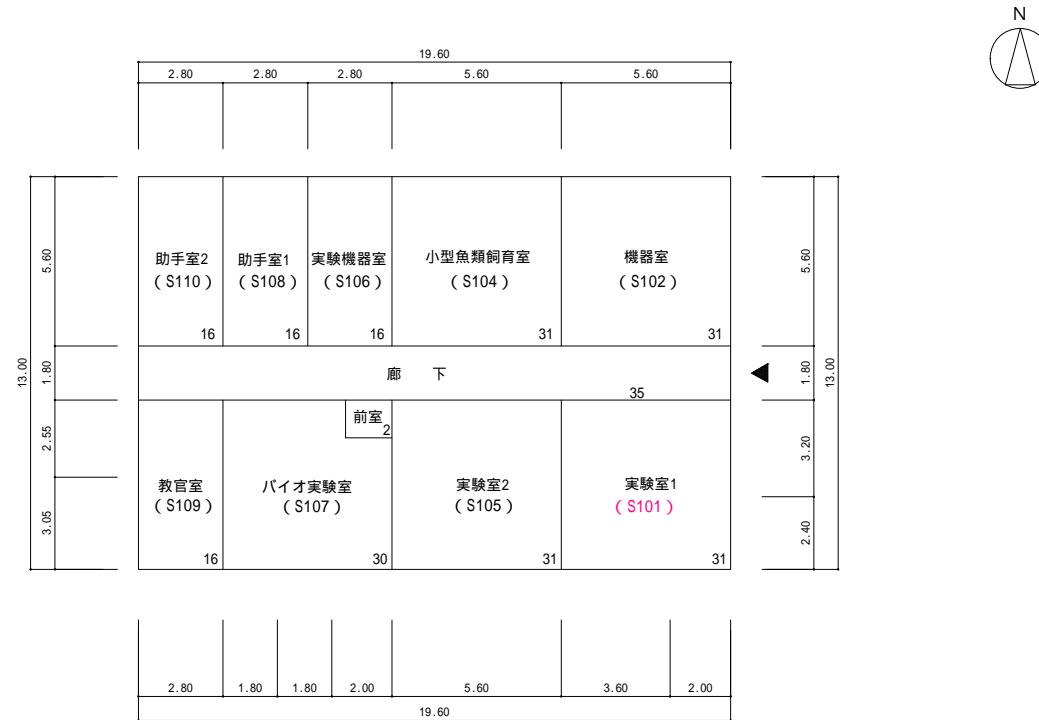

T 微生物附属棟 2006.5.1

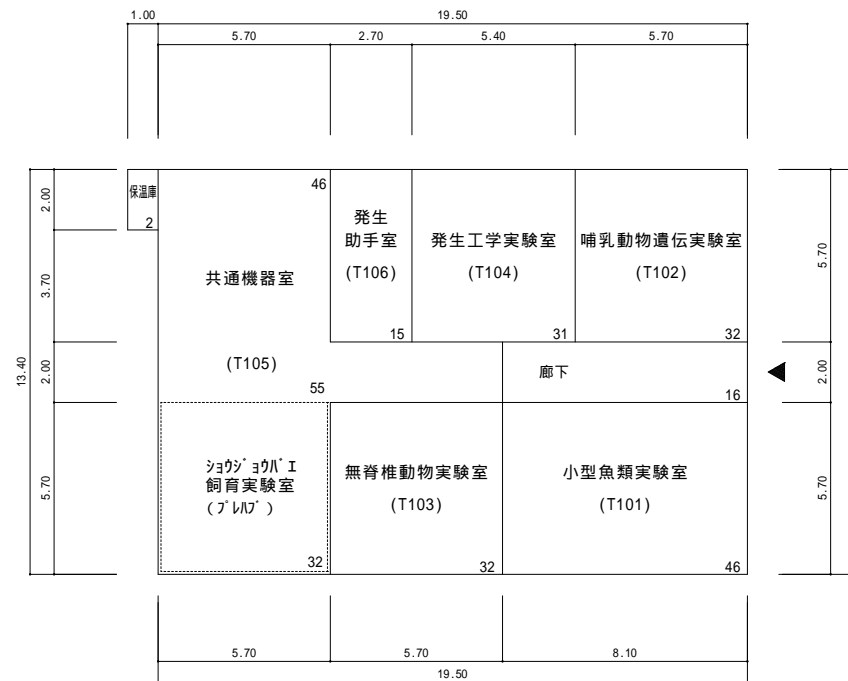

1階平面図 S.56 S=1/250 263m²

U ネズミ附属棟 2006.5.1

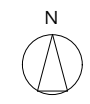
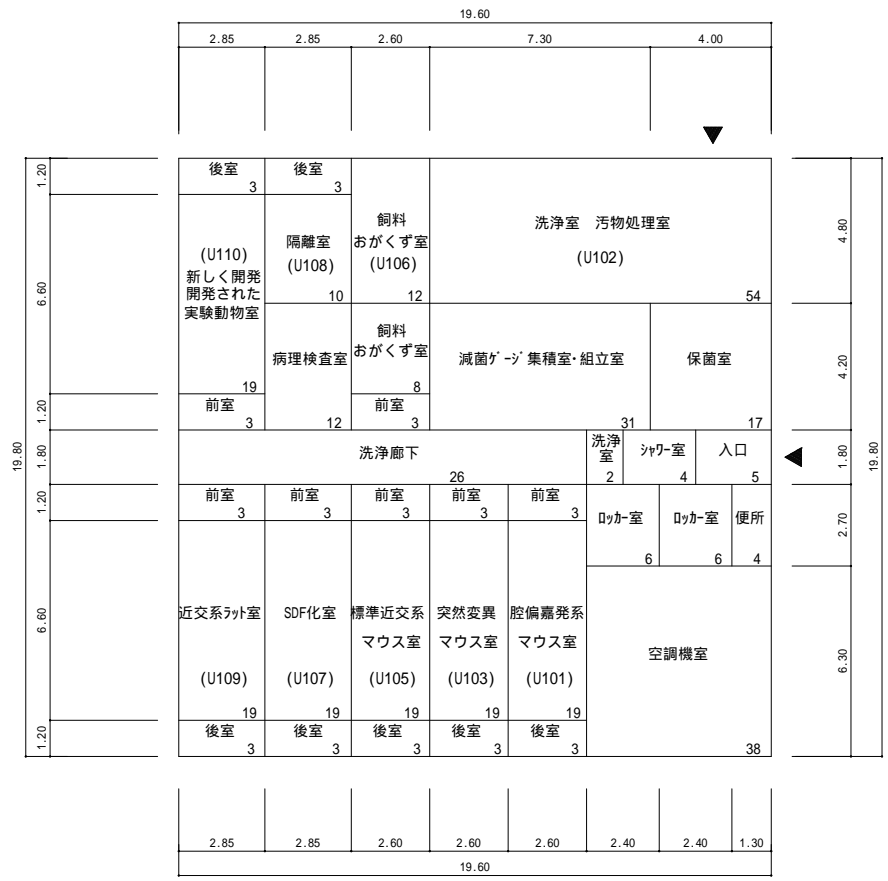

1階 388m²
S = 1 / 250

V 実験圃場管理棟 2006.5.1

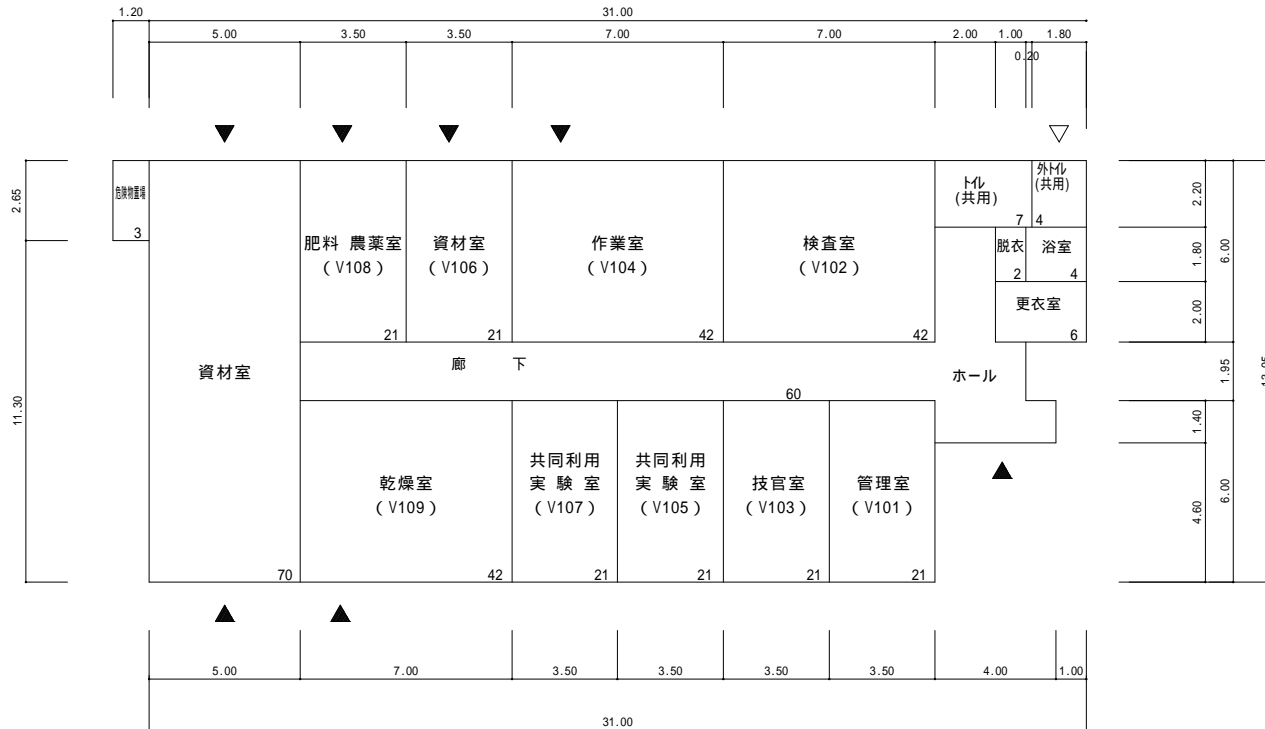

1階平面図 S.60 S=1/250 408m²

W 生命情報・DDBJ研究センター

2006.5.8

部屋番号整理及び新設

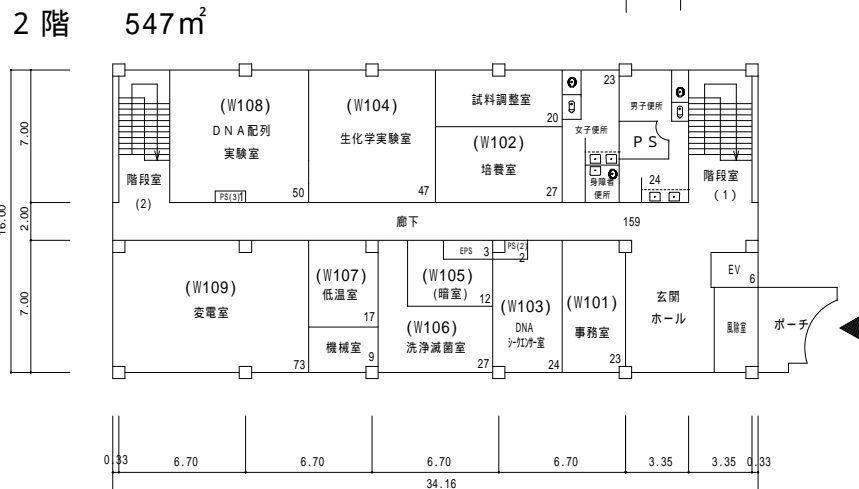
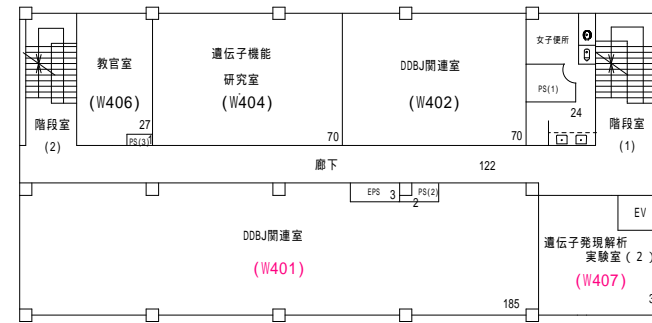
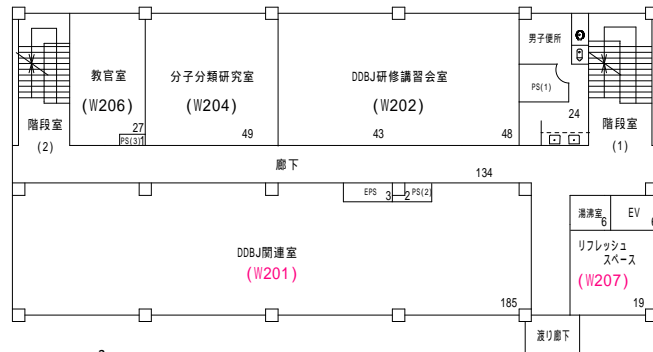
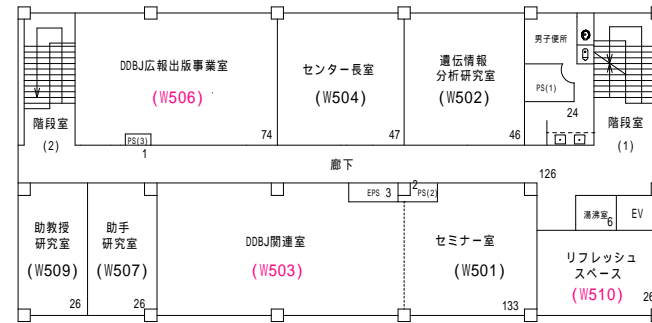
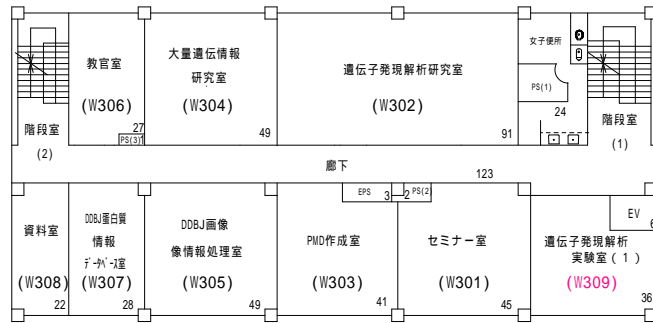

X 動物飼育実験棟 2006.5.1

部屋番号新設

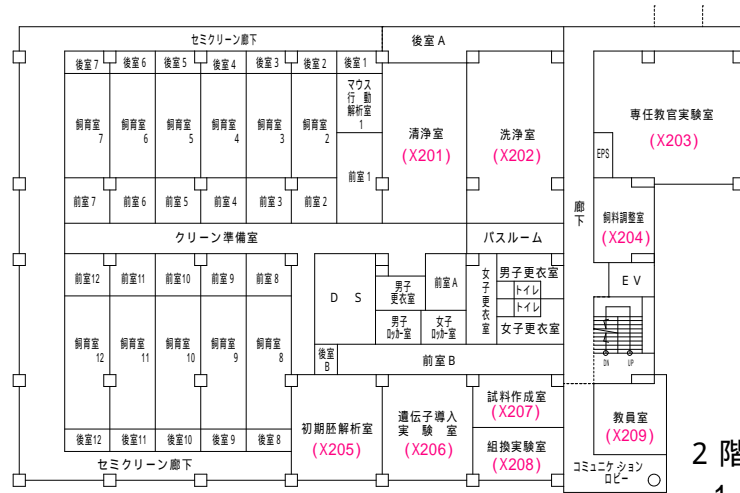

2階平面図
1,334m²

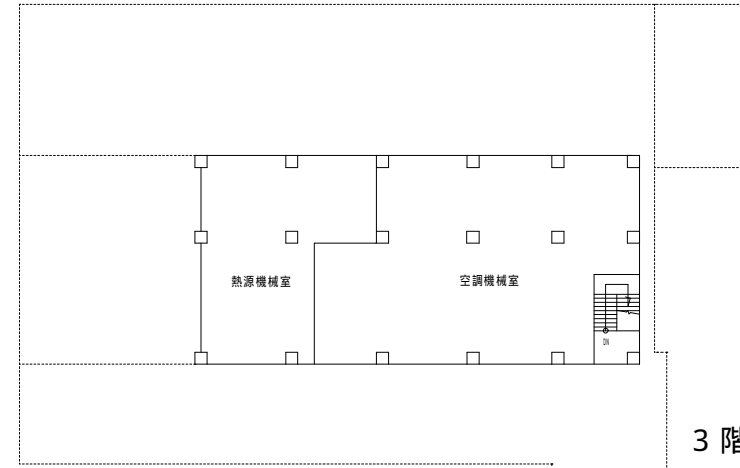

3階平面図
396m²

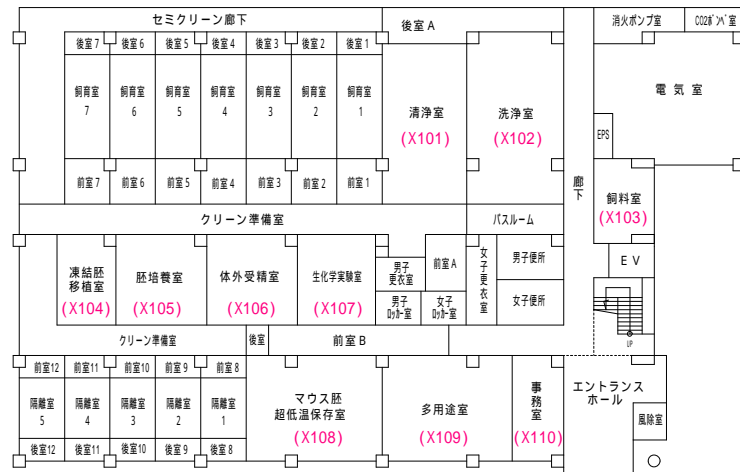

1階平面図
1,331m²

$$S = 1 / 500$$

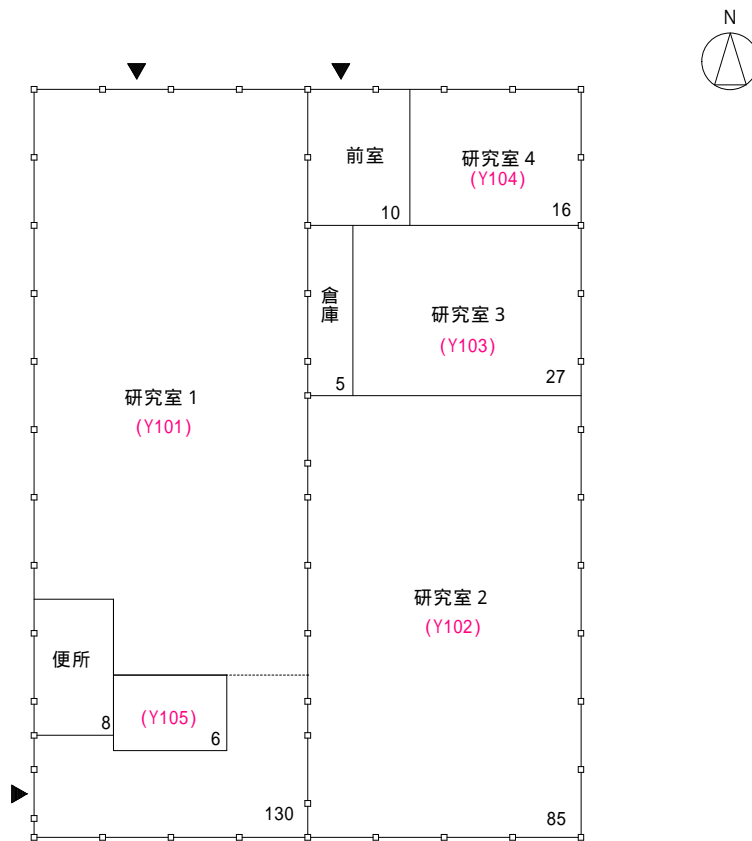

構造センター東側プレハブ1階平面図 S=1/250